



# The Sizewell C Project

---

## 2.7 Southern Park and Ride Plans For Approval

---

January 2021

Planning Act 2008  
Infrastructure Planning (Applications: Prescribed Forms and Procedure) Regulations 2009

Revision: 2.0  
Applicable Regulation: Regulation 5(2)(o)  
PINS Reference Number: EN010012



# Southern Park and Ride Plans – For Approval

Drawing Number	Revision	Drawing Title	Scale	Sheet Size
SZC-SZ0204-FP-000-DRW-100056	02	Southern Park And Ride Proposed Parameter Plan	1:2000	A1
SZC-SZ0204-FP-000-DRW-100009	02	Southern Park And Ride Proposed General Arrangement	1:2000	A1
SZC-SZ0701-XX-000-DRW-100163	02	Southern Park And Ride Site Clearance Plan	1:2500	A1
SZC-SZ0701-XX-000-DRW-100164	02	Southern Park And Ride Proposed Landscape Masterplan And Finished Levels	1:2500	A1
SZC-SZ0701-XX-000-DRW-100165	02	Southern Park And Ride Removal And Reinstatement Plan	1:2500	A1
SZC-SZ0204-XX-000-DRW-100525	02	Southern Park And Ride Highway Proposed General Arrangement Key Plan	1:2000	A1
SZC-SZ0204-XX-000-DRW-100526	02	Southern Park And Ride Highway Proposed General Arrangement - Sheet 1 of 3	1:500	A1
SZC-SZ0204-XX-000-DRW-100527	02	Southern Park And Ride Highway Proposed General Arrangement - Sheet 2 of 3	1:500	A1
SZC-SZ0204-XX-000-DRW-100528	02	Southern Park And Ride Highway Proposed General Arrangement - Sheet 3 of 3	1:500	A1

# Southern Park and Ride Plans For Approval – Revisions Schedule

Drawing Number	Revision	Drawing Title	Amendments
SZC-SZ0204-FP-000-DRW-100056	02	Southern Park And Ride Proposed Parameter Plan	Reduction due to review of land ownership boundaries and design development
SZC-SZ0204-FP-000-DRW-100009	02	Southern Park And Ride Proposed General Arrangement	Reduction due to review of land ownership boundaries and design development
SZC-SZ0701-XX-000-DRW-100163	02	Southern Park And Ride Site Clearance Plan	Reduction due to review of land ownership boundaries and design development
SZC-SZ0701-XX-000-DRW-100164	02	Southern Park And Ride Proposed Landscape Masterplan And Finished Levels	Reduction due to review of land ownership boundaries and design development
SZC-SZ0701-XX-000-DRW-100165	02	Southern Park And Ride Removal And Reinstatement Plan	Reduction due to review of land ownership boundaries and design development
SZC-SZ0204-XX-000-DRW-100525	02	Southern Park And Ride Highway Proposed General Arrangement Key Plan	Reduction due to review of land ownership boundaries and design development
SZC-SZ0204-XX-000-DRW-100526	02	Southern Park And Ride Highway Proposed General Arrangement - Sheet 1 of 3	Reduction due to review of land ownership boundaries and design development
SZC-SZ0204-XX-000-DRW-100527	02	Southern Park And Ride Highway Proposed General Arrangement - Sheet 2 of 3	Reduction due to review of land ownership boundaries and design development
SZC-SZ0204-XX-000-DRW-100528	02	Southern Park And Ride Highway Proposed General Arrangement - Sheet 3 of 3	Reduction due to review of land ownership boundaries and design development

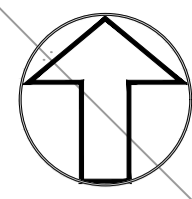

**NOTES:**

- 1. Do not scale from this drawing. All dimensions are in metres unless noted otherwise.

**KEY:**

- DEVELOPMENT SITE BOUNDARY
- ZONE 1
  - TO INCLUDE:
    - OPERATIONAL PARK & RIDE FACILITY INCLUDING TIME
- ZONE 1A
  - TO INCLUDE:
    - AMENITY WELFARE BUILDING UP TO 4M
    - SECURITY BUILDING UP TO 4M
    - BUS SHELTERS UP TO 3M
    - POSTAL CONSOLIDATION BUILDING UP TO 4M
    - SHELTERS (SMOKING/CYCLE)
- ZONE 2
  - TO INCLUDE:
    - ACCESS ROAD
    - SECURITY BOOTH UP TO 4M
    - EXIT LOOP
- ZONE 3
  - TO INCLUDE:
    - INDICATIVE POSITION OF LANDSCAPE BUND UP TO 3M

02	JAN 2021	NKS	KA	PROPOSED CHANGES TO THE DCO APPLICATION - JANUARY 2021	PJ
01	FEB 2020	NKS	KA	DCO SUBMISSION	PJ
REVISION	DATE	DRAWN/CHECKED	REASONS FOR REVISION / COMMENTS		APPROVED

NOT PROTECTIVELY MARKED

**COPYRIGHT:**  
 Reproduced from Ordnance Survey map with the permission of Ordnance Survey on behalf of the controller of Her Majesty's Stationery Office © Crown copyright (2021). All Rights reserved. NNB GenCo Licence: 0100060408



PROJECT:  
SIZEWELL C

DOCUMENT:  
APPLICATION DRAWING - FOR APPROVAL  
REGULATION 5(2)(c)

DRAWING TITLE:  
SOUTHERN PARK AND RIDE  
PROPOSED PARAMETER PLAN

DRAWING NO: SZC-SZ0204-FP-000-DRW-100056	REVISION: 02
---	-----------------

DATE: JAN 2021	DRAWN: NKS	SCALE: 1:2000@A1
-------------------	---------------	---------------------

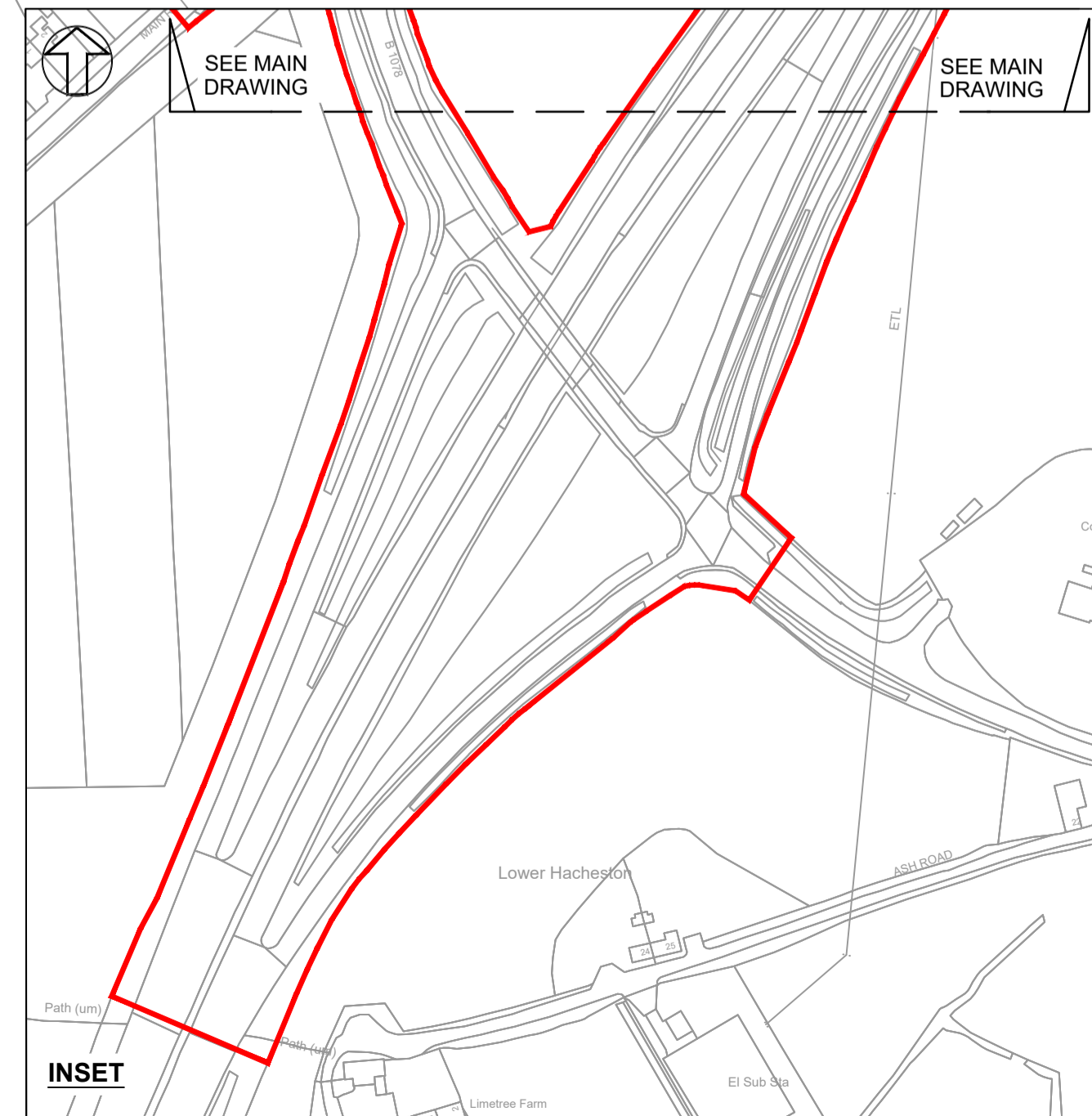
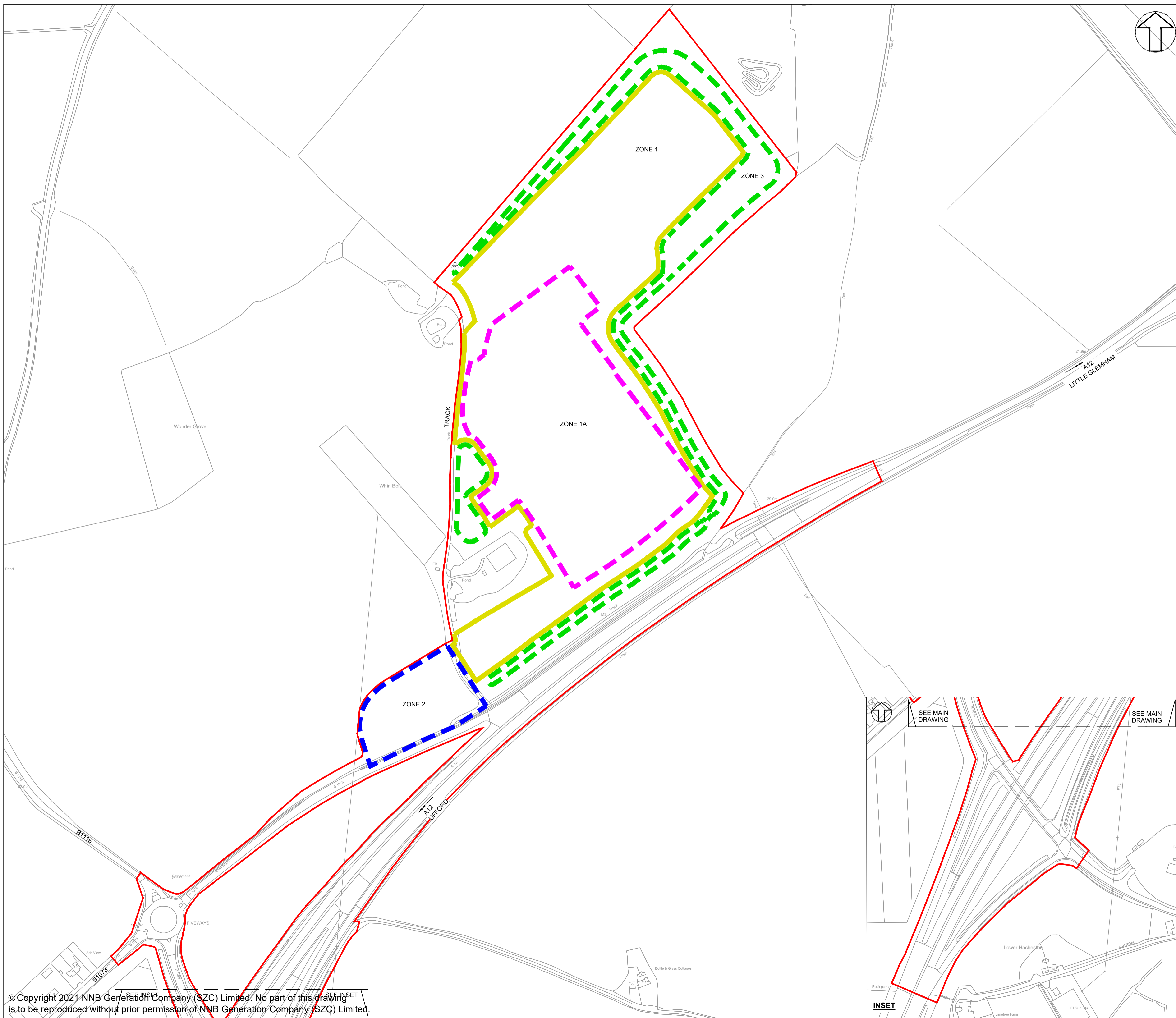
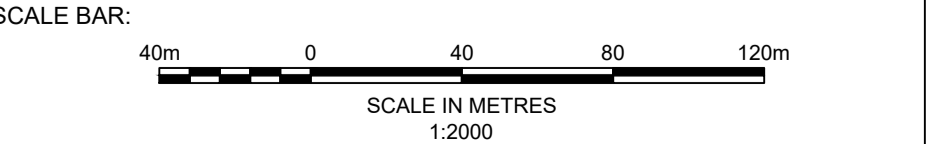

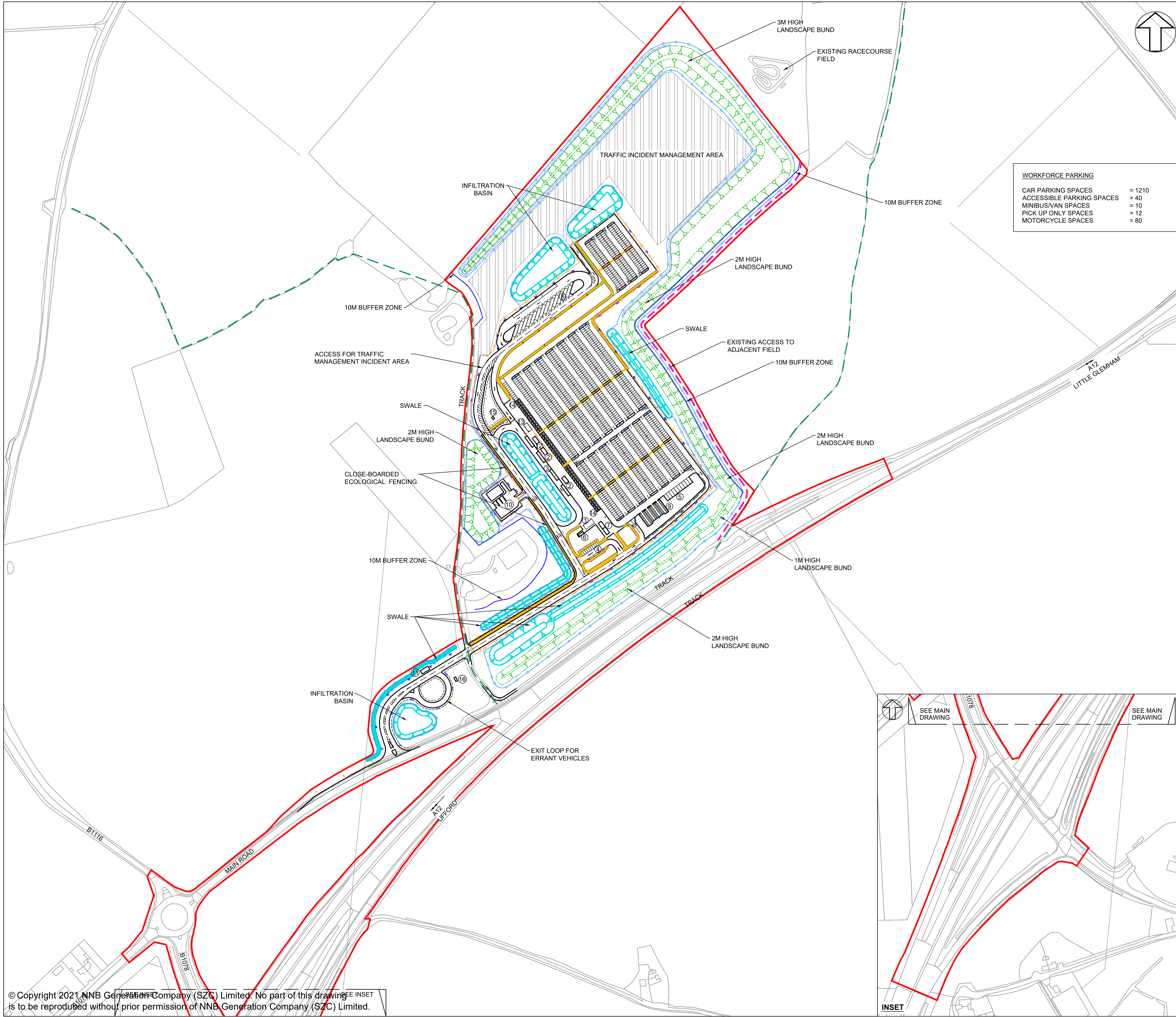

WORKFORCE PARKING	
CAR PARKING SPACES	= 1210
ACCESSIBLE PARKING SPACES	= 40
MINIBUS/VAN SPACES	= 10
PICK UP ONLY SPACES	= 12
MOTORCYCLE SPACES	= 80

**NOTES:**  
 1. Do not scale from this drawing. All dimensions are in metres unless noted otherwise.  
 2. For Lighting Column specifications see drawings SZC-SZ0204-FP-000-DRW-100011-13, 100054 and 100099.

- KEY:**
- DEVELOPMENT SITE BOUNDARY
  - ① AMENITY AND WELFARE BUILDING
  - ② BUS SHELTERS
  - ③ BUS STOPS
  - ④ DROP OFF
  - ⑤ VAN / MINIBUS PARKING
  - ⑥ SMOKING SHELTER
  - ⑦ CYCLE SHELTER
  - ⑧ OVERNIGHT BUS PARKING
  - ⑨ MOTORCYCLE PARKING
  - ⑩ POSTAL CONSOLIDATION BUILDING
  - ⑪ SECURITY BOOTH
  - ⑫ SECURE BUS TERMINAL
  - ⑬ SECURITY BUILDING
  - ⑭ ACCESSIBLE PARKING
  - ⑮ PACKAGE TREATMENT PLANT
  - ⑯ SEPTIC TANK
  - BUFFER ZONE
  - SECURITY FENCE (1.8M HIGH)
  - ECOLOGICAL FENCING
  - GATE
  - SWALE / INFILTRATION BASIN (INDICATIVE)
  - LANDSCAPE BUND
  - PEDESTRIAN WALKWAY
  - MANUAL RISING ARM BARRIER
  - EXISTING PUBLIC RIGHT OF WAY
  - PROPOSED DITCH (INDICATIVE)
  - PROPOSED LIGHTING COLUMNS(INDICATIVE)
  - LIGHTING LANTERN DEMOUNTABLE SHIELD
  - EXISTING ACCESS TO ADJACENT FIELD

REVISION	DATE	DRAWN	CHECKED	REASONS FOR REVISION / COMMENTS	APPROVED
02	JAN 2021	NKS	KA	PROPOSED CHANGES TO THE DCO APPLICATION - JANUARY 2021	PJ

NOT PROTECTIVELY MARKED

**COPYRIGHT:**  
 Reproduced from Ordnance Survey map with the permission of Ordnance Survey on behalf of the controller of Her Majesty's Stationery Office © Crown copyright (2021). All Rights reserved. NNB GenCo Licence: 0100060408



PROJECT:  
**SIZEWELL C**

DOCUMENT:  
**APPLICATION DRAWING - FOR APPROVAL REGULATION 5(2)(c)**

DRAWING TITLE:  
**SOUTHERN PARK AND RIDE PROPOSED GENERAL ARRANGEMENT**

DRAWING NO:  
**SZC-SZ0204-FP-000-DRW-100009**

REVISION:  
**02**

DATE: **JAN 2021** DRAWN: **NKS** SCALE: **1:2000@A1**

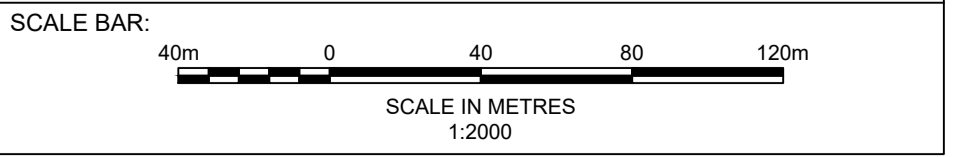

© Copyright 2021 NNB Generation Company (SZC) Limited. No part of this drawing is to be reproduced without prior permission of NNB Generation Company (SZC) Limited.

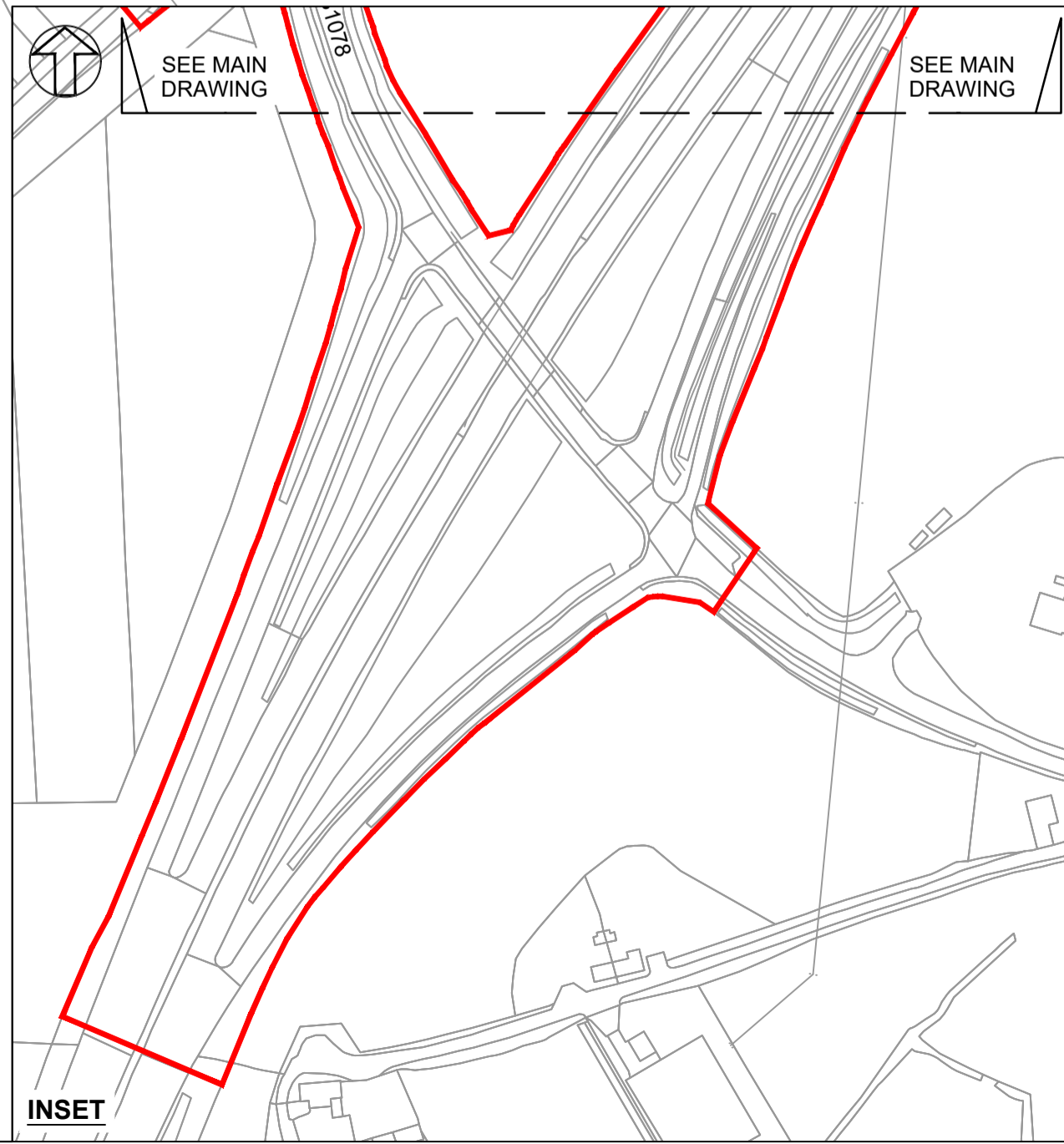

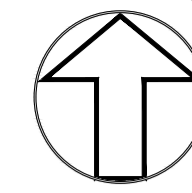

**NOTES:**

- FOR DETAILS OF PERMANENT AND TEMPORARY POSSESSION WITHIN ORDER LIMITS REFER TO LAND PLANS.
- THE LOCATIONS OF FEATURES SHOWN ARE INDICATIVE ONLY. EXACT LOCATIONS TO BE CONFIRMED ON SITE.
- ADDITIONAL FEATURES MAY BE PRESENT ON SITE THAT HAVE NOT BEEN IDENTIFIED.
- THIS DRAWING IS BASED ON AERIAL PHOTOGRAPHS AND SITE VISITS.
- FOR HEDGEROW REFERENCES (H01-H10) PLEASE REFER TO SCHEDULE 21 OF DRAFT DCO (DOC REF 3.1)
- WITHIN THE AREA SHOWN AS 'GENERAL SITE CLEARANCE' NOT EVERYTHING WOULD BE CLEARED. SITE CLEARANCE WOULD BE THE MINIMUM REQUIRED TO UNDERTAKE THE WORKS. GENERAL SITE CLEARANCE CONSISTS OF REMOVAL OF OVERGROWN VEGETATION IN VERGES AND TOPSOIL REMOVAL.

**KEY:**

- DEVELOPMENT SITE BOUNDARY
- RETAINED HEDGEROW
- RETAINED IMPORTANT HEDGEROW (HEDGEROW REGULATIONS 1997)
- RETAINED TREES AND SHRUBS
- DRY POND TO BE RETAINED
- BUFFER ZONE
- AREA OF GENERAL SITE CLEARANCE FOR CONSTRUCTION WORKS WITHIN THE SITE
- VEGETATION TO BE REMOVED
- IMPORTANT HEDGEROW (HEDGEROW REGULATIONS 1997) TO BE REMOVED

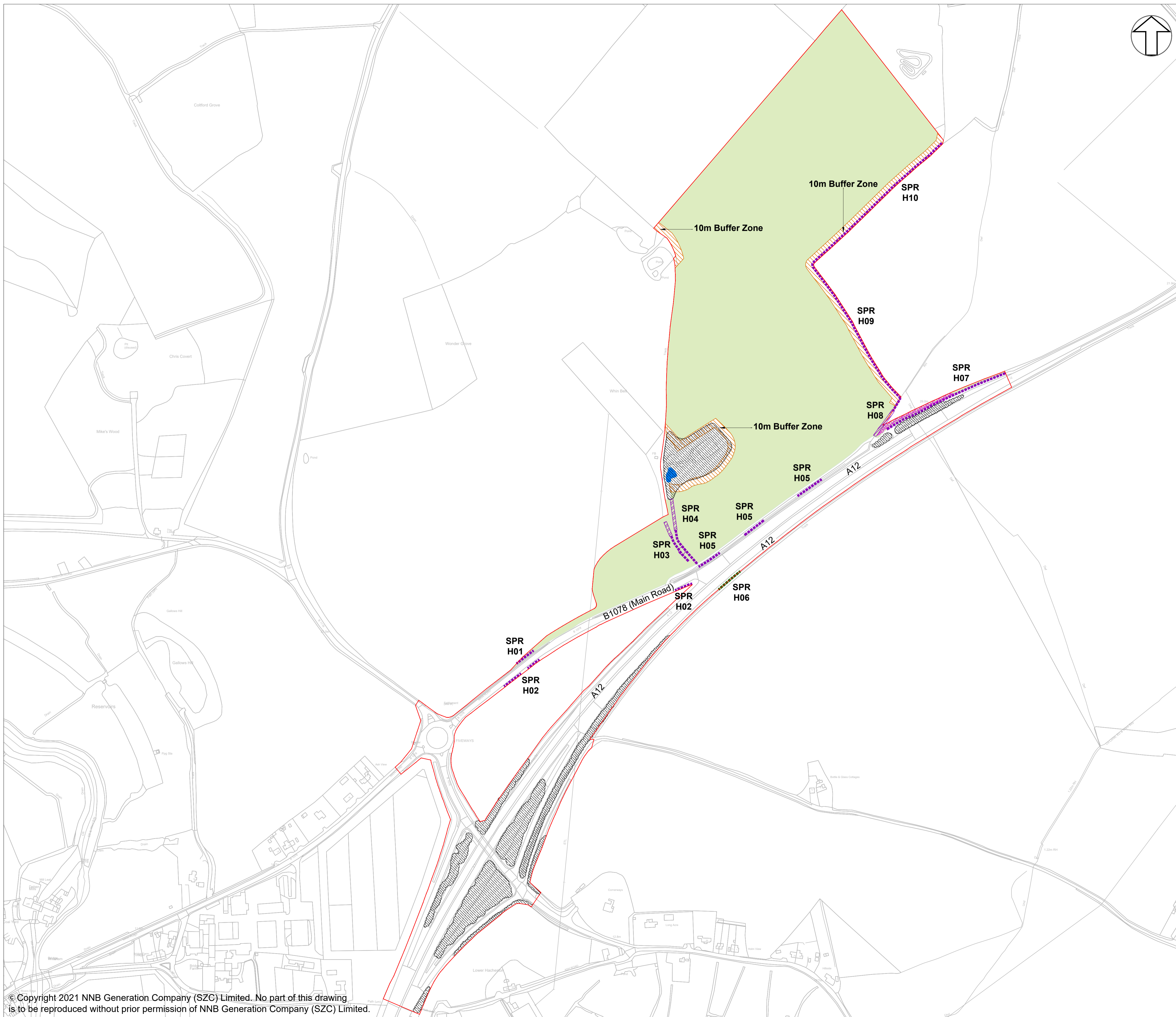

02	JAN 2021	LDA	LDA	PROPOSED CHANGES TO THE DCO APPLICATION - JANUARY 2021	SZC Co.
01	FEB 2020	LDA	LDA	DCO SUBMISSION	SZC Co.
REVISION	DATE	DRAWN/CHECKED	REASONS FOR REVISION / COMMENTS		APPROVED

NOT PROTECTIVELY MARKED

**COPYRIGHT:**

Reproduced from Ordnance Survey map with the permission of Ordnance Survey on behalf of the controller of Her Majesty's Stationery Office © Crown copyright (2021). All Rights reserved. NNB GenCo Licence: 0100060408



PROJECT:  
SIZEWELL C

DOCUMENT:  
APPLICATION DRAWING - FOR APPROVAL  
REGULATION 5(2)(c)

DRAWING TITLE:  
SOUTHERN PARK AND RIDE  
SITE CLEARANCE PLAN

DRAWING NO: SZC-SZ0701-XX-000-DRW-100163 REVISION: 02

DATE: JAN 2021 DRAWN: T.H. SCALE: 1:2500 @ A1

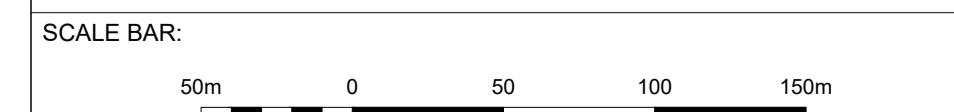

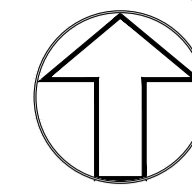

**NOTES:**

1. FOR DETAILS OF PERMANENT AND TEMPORARY POSSESSION WITHIN ORDER LIMITS REFER TO LAND PLANS

**KEY:**

- DEVELOPMENT SITE BOUNDARY
- **SOFTWORKS - EXISTING**
- - - - - RETAINED HEDGEROW
- - - - - RETAINED IMPORTANT HEDGEROW (HEDGEROW REGULATIONS 1997)
- RETAINED AND ENHANCED TREES AND SHRUBS
- - - - - **SOFTWORKS - PROPOSED**
- - - - - HEDGEROW PLANTING
- NATIVE TREE PLANTING (INDICATIVE LOCATION)
- NATIVE TREE SHRUB PLANTING
- DRY POND TO BE RETAINED
- GRASSLAND - RETAINED, REINSTATED OR TEMPORARY LAND COVER
- - - - - EXISTING ACCESS TO ADJACENT FIELD
- - - - - **HARDWORKS - PROPOSED**
- - - - - SECURITY FENCE (1.8M HIGH)
- SECURE GATE AND BARRIER ACCESS
- - - - - ECOLOGICAL FENCE
- VEHICLE SURFACING
- PEDESTRIAN SURFACING
- TRAFFIC INCIDENT MANAGEMENT AREA (TIMA)
- **BUILDINGS - PROPOSED**
- BUILDING FOOTPRINT
- BUS / SMOKING / CYCLE SHELTER
- INDICATIVE LIGHTING COLUMN
- - - - - **EARTHWORKS / INDICATIVE DRAINAGE - PROPOSED**
- - - - - BUND
- - - - - SWALE
- - - - - DITCH

02	JAN 2021	LDA	LDA	PROPOSED CHANGES TO THE DCO APPLICATION - JANUARY 2021	SZC Co.
01	FEB 2020	LDA	LDA	DCO SUBMISSION	SZC Co.
REVISION	DATE	DRAWN/CHECKED	REASONS FOR REVISION / COMMENTS		APPROVED

NOT PROTECTIVELY MARKED

**COPYRIGHT:**

Reproduced from Ordnance Survey map with the permission of Ordnance Survey on behalf of the controller of Her Majesty's Stationery Office © Crown copyright (2021). All Rights reserved. NNB GenCo Licence: 0100060408



PROJECT:  
SIZEWELL C

DOCUMENT:  
APPLICATION DRAWING - FOR APPROVAL  
REGULATION 5(2)(c)

DRAWING TITLE:  
SOUTHERN PARK AND RIDE  
PROPOSED LANDSCAPE MASTERPLAN  
AND FINISHED LEVELS

DRAWING NO:  
SZC-SZ0701-XX-000-DRW-100164

REVISION:  
02

DATE: JAN 2021

DRAWN: T.H.

SCALE: 1:2500 @ A1

SCALE BAR:  
0 50 100 150m

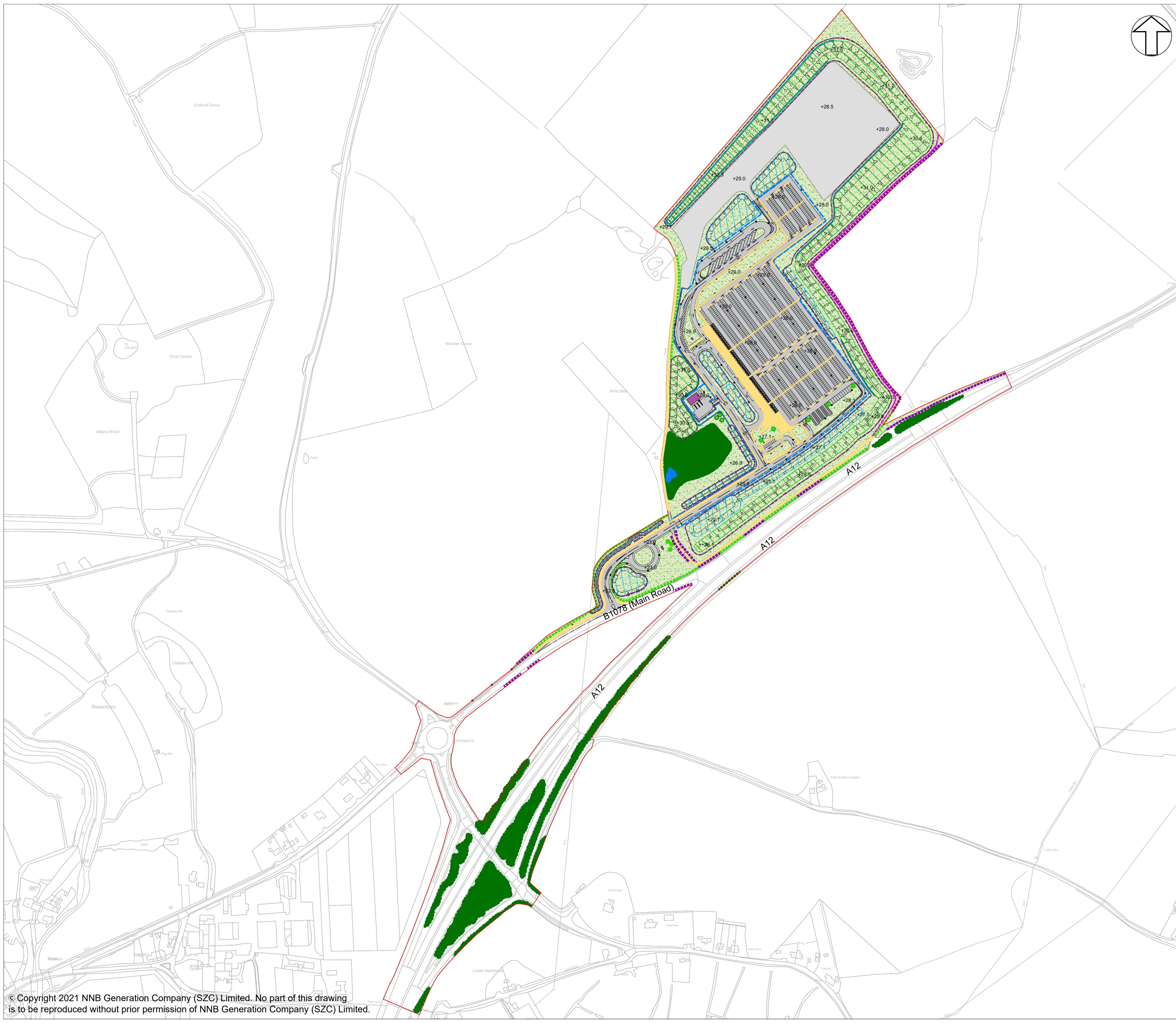

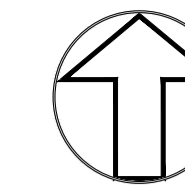

NOTES:

KEY:

- DEVELOPMENT SITE BOUNDARY
- SOFTWORKS - RETAINED**
- RETAINED HEDGEROW
- RETAINED IMPORTANT HEDGEROW (HEDGEROW REGULATIONS 1997)
- RETAINED AND ENHANCED TREES AND SHRUBS
- DRY POND TO BE RETAINED
- SOFTWORKS - PROPOSED**
- HEDGEROW PLANTING
- AGRICULTURAL LAND REINSTATED

02	JAN 2021	LDA	LDA	PROPOSED CHANGES TO THE DCO APPLICATION - JANUARY 2021	SZC Co.
01	FEB 2020	LDA	LDA	DCO SUBMISSION	SZC Co.
REVISION	DATE	DRAWN/CHECKED	REASONS FOR REVISION / COMMENTS		APPROVED

NOT PROTECTIVELY MARKED

COPYRIGHT:

Reproduced from Ordnance Survey map with the permission of Ordnance Survey on behalf of the controller of Her Majesty's Stationery Office © Crown copyright (2021). All Rights reserved. NNB GenCo Licence: 0100060408



PROJECT:  
SIZEWELL C

DOCUMENT:  
APPLICATION DRAWING - FOR APPROVAL  
REGULATION 5(2)(c)

DRAWING TITLE:  
SOUTHERN PARK AND RIDE  
REMOVAL AND REINSTATEMENT PLAN

DRAWING NO: SZC-SZ0701-XX-000-DRW-100165 REVISION: 02

DATE: JAN 2021 DRAWN: T.H. SCALE: 1:2500 @ A1

SCALE BAR:  
0 50 100 150m

Temporary planting around operational site access layout to be removed and original hedgerow layouts replanted with native species to connect existing planting.

Site operational highway layout to be removed and existing highway layout reinstated





- NOTES
1. THIS DRAWING IS FOR PLANNING PURPOSES ONLY AND SHALL NOT BE USED FOR CONSTRUCTION OR ANY OTHER PURPOSE.
  2. THE SCHEME DESIGN IS BASED ON ORDNANCE SURVEY MAPPING DATA. THE EXISTING GROUND TERRAIN AND PROPOSED SURFACES ARE BASED ON THE UK GOVERNMENT'S OPEN SOURCE LIDAR DIGITAL TERRAIN MAPPING DATA. ALL POSITIONS AND LEVELS ARE TO BE REVIEWED FOLLOWING COMPLETION OF A DETAILED SITE TOPOGRAPHICAL SURVEY.
  3. NEW SIGNS AND ROAD MARKINGS WILL BE BASED ON TSRGD 2016 OR AS AGREED WITH THE LOCAL HIGHWAY AUTHORITY.
  4. ALL DIMENSIONS IN METRES UNLESS STATED OTHERWISE.
  5. FOR DETAILS OF LANDSCAPING AND PLANTING REFER TO THE LANDSCAPE ARCHITECTS PLANS.
  6. ALL PROPOSED ROADWORKS ARE TO BE IN ACCORDANCE WITH THE DESIGN MANUAL FOR ROADS AND BRIDGES (DMRB OR AS AGREED WITH LOCAL AUTHORITY).
  7. WHERE PROPOSED ROAD MARKINGS ARE SHOWN THE EXISTING ROAD MARKINGS ARE TO BE REMOVED AS APPROPRIATE.

KEY:

——— DEVELOPMENT SITE BOUNDARY

REVISION	DATE	DRAWN/CHECKED	REASONS FOR REVISION / COMMENTS	APPROVED	
02	JAN 2021	DHP	HWP	PROPOSED CHANGES TO THE DCO APPLICATION - JANUARY 2021	SZC Co
01	FEB 2020	DHP	HWP	DCO SUBMISSION	SZC Co

NOT PROTECTIVELY MARKED

**COPYRIGHT:**  
 Reproduced from Ordnance Survey map with the permission of Ordnance Survey on behalf of the controller of Her Majesty's Stationery Office © Crown copyright (2021). All Rights reserved. NNB GenCo Licence: 0100060408



PROJECT:  
**SIZEWELL C**

DOCUMENT:  
**APPLICATION DRAWING - FOR APPROVAL REGULATION 5(2)(o)**

DRAWING TITLE:  
**SOUTHERN PARK AND RIDE HIGHWAY PROPOSED GENERAL ARRANGEMENT KEY PLAN**

DRAWING NO:  
**SZC-SZ0204-XX-000-DRW-100525**

REVISION:  
**02**

DATE: **JAN 2021**      DRAWN: **DHP**      SCALE: **1:2000 @ A1**

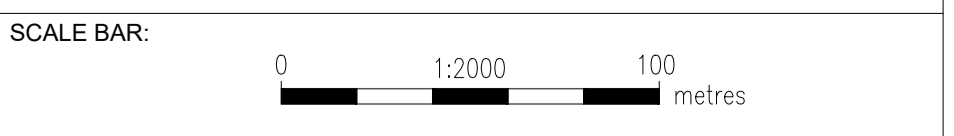

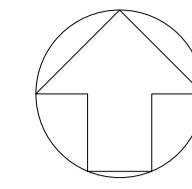

See Drawing No: SCZ-SZ0204-XX-000-DRW-100527



- NOTES
1. THIS DRAWING IS FOR PLANNING PURPOSES ONLY AND SHALL NOT BE USED FOR CONSTRUCTION OR ANY OTHER PURPOSE.
  2. THE SCHEME DESIGN IS BASED ON ORDNANCE SURVEY MAPPING DATA. THE EXISTING GROUND TERRAIN AND PROPOSED SURFACES ARE BASED ON THE UK GOVERNMENT'S OPEN SOURCE LIDAR DIGITAL TERRAIN MAPPING DATA. ALL POSITIONS AND LEVELS ARE TO BE REVIEWED FOLLOWING COMPLETION OF A DETAILED SITE TOPOGRAPHICAL SURVEY.
  3. NEW SIGNS AND ROAD MARKINGS WILL BE BASED ON TSRGD 2016 OR AS AGREED WITH THE LOCAL HIGHWAY AUTHORITY.
  4. ALL DIMENSIONS IN METRES UNLESS STATED OTHERWISE.
  5. FOR DETAILS OF LANDSCAPING AND PLANTING REFER TO THE LANDSCAPE ARCHITECTS PLANS.
  6. ALL PROPOSED ROADWORKS ARE TO BE IN ACCORDANCE WITH THE DESIGN MANUAL FOR ROADS AND BRIDGES (DMRB) OR AS AGREED WITH LOCAL AUTHORITY.
  7. WHERE PROPOSED ROAD MARKINGS ARE SHOWN THE EXISTING ROAD MARKINGS ARE TO BE REMOVED AS APPROPRIATE.

KEY:

-  DEVELOPMENT SITE BOUNDARY
-  EXISTING LAY-BY
-  PROPOSED ROAD MARKING



02	JAN 2021	DHP	HWP	PROPOSED CHANGES TO THE DCO APPLICATION - JANUARY	SZC Co
01	FEB 2020	DHP	HWP	DCO SUBMISSION	SZC Co
REVISION	DATE	DRAWN/CHECKED		REASONS FOR REVISION / COMMENTS	APPROVED

NOT PROTECTIVELY MARKED

**COPYRIGHT:**  
 Reproduced from Ordnance Survey map with the permission of Ordnance Survey on behalf of the controller of Her Majesty's Stationery Office © Crown copyright (2021). All Rights reserved. NNB GenCo Licence: 0100060408



PROJECT:  
SIZEWELL C

DOCUMENT:  
APPLICATION DRAWING - FOR APPROVAL REGULATION 5(2)(o)

DRAWING TITLE:  
SOUTHERN PARK AND RIDE HIGHWAY PROPOSED GENERAL ARRANGEMENT SHEET 1 OF 3

DRAWING NO: SZC-SZ0204-XX-000-DRW-100526 REVISION: 02

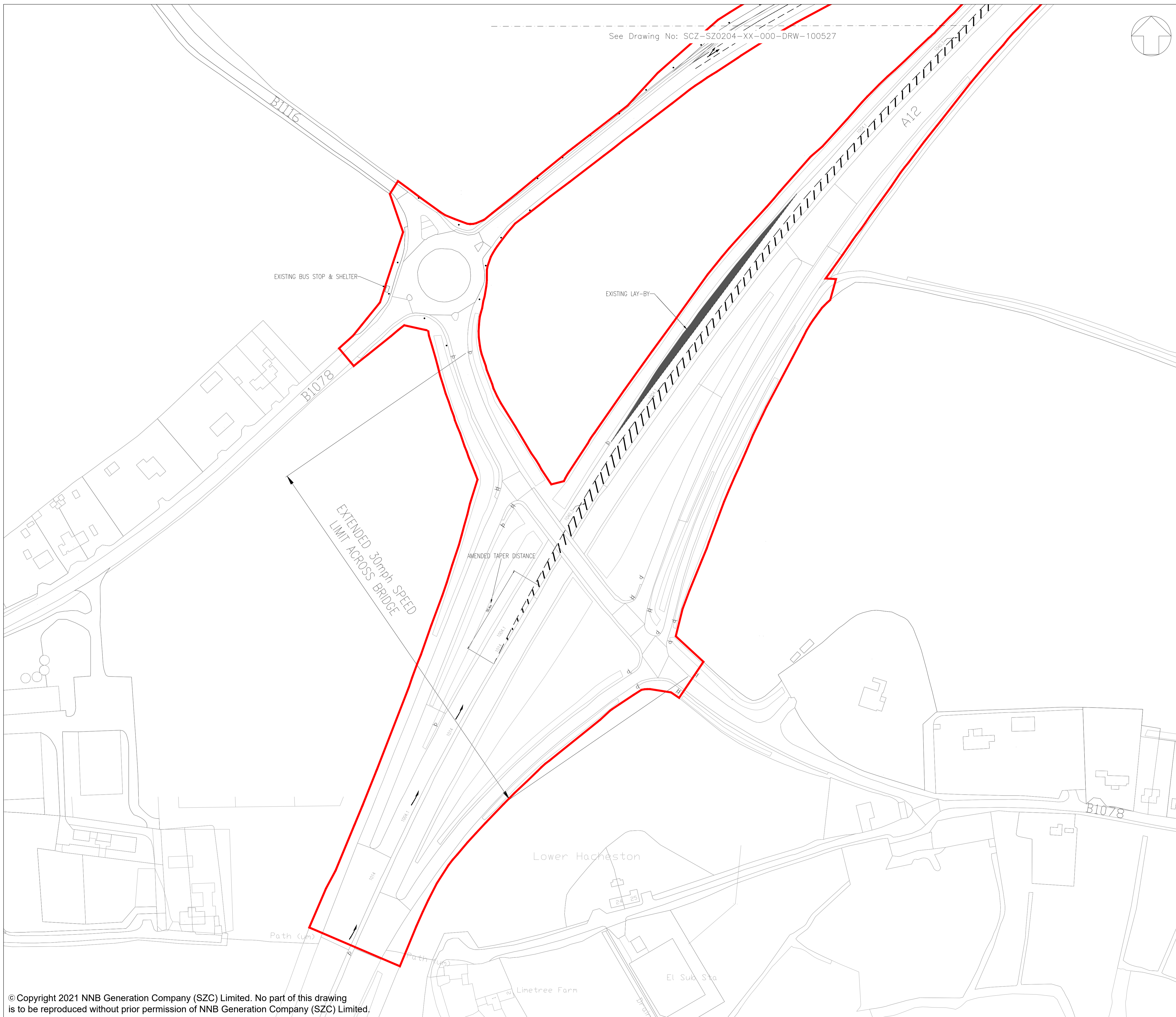
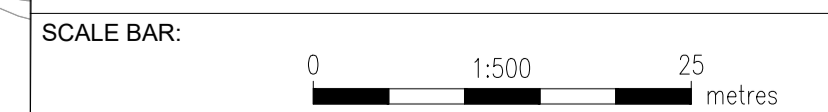

DATE: JAN 2021 DRAWN: DHP SCALE: 1:500 @ A1

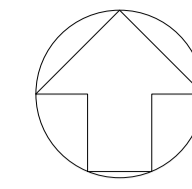



- NOTES
1. THIS DRAWING IS FOR PLANNING PURPOSES ONLY AND SHALL NOT BE USED FOR CONSTRUCTION OR ANY OTHER PURPOSE.
  2. THE SCHEME DESIGN IS BASED ON ORDNANCE SURVEY MAPPING DATA. THE EXISTING GROUND TERRAIN AND PROPOSED SURFACES ARE BASED ON THE UK GOVERNMENT'S OPEN SOURCE LIDAR DIGITAL TERRAIN MAPPING DATA. ALL POSITIONS AND LEVELS ARE TO BE REVIEWED FOLLOWING COMPLETION OF A DETAILED SITE TOPOGRAPHICAL SURVEY.
  3. NEW SIGNS AND ROAD MARKINGS WILL BE BASED ON TSRGD 2016 OR AS AGREED WITH THE LOCAL HIGHWAY AUTHORITY.
  4. ALL DIMENSIONS IN METRES UNLESS STATED OTHERWISE.
  5. FOR DETAILS OF LANDSCAPING AND PLANTING REFER TO THE LANDSCAPE ARCHITECTS PLANS.
  6. ALL PROPOSED ROADWORKS ARE TO BE IN ACCORDANCE WITH THE DESIGN MANUAL FOR ROADS AND BRIDGES (DMRB) OR AS AGREED WITH LOCAL AUTHORITY.
  7. WHERE PROPOSED ROAD MARKINGS ARE SHOWN THE EXISTING ROAD MARKINGS ARE TO BE REMOVED AS APPROPRIATE.

KEY:

-  DEVELOPMENT SITE BOUNDARY
-  EXISTING LAY BY
-  PROPOSED ROAD MARKING



02	JAN 2021	DHP	HWP	PROPOSED CHANGES TO THE DCO APPLICATION - JANUARY 2021	SZC Co
01	FEB 2020	DHP	HWP	DCO SUBMISSION	SZC Co
REVISION	DATE	DRAWN/CHECKED		REASONS FOR REVISION / COMMENTS	APPROVED

NOT PROTECTIVELY MARKED

**COPYRIGHT:**  
 Reproduced from Ordnance Survey map with the permission of Ordnance Survey on behalf of the controller of Her Majesty's Stationery Office © Crown copyright (2021). All Rights reserved. NNB GenCo Licence: 0100060408



PROJECT:  
 SIZEWELL C

DOCUMENT:  
 APPLICATION DRAWING - FOR APPROVAL  
 REGULATION 5(2)(o)

DRAWING TITLE:  
 SOUTHERN PARK AND RIDE  
 HIGHWAY PROPOSED GENERAL  
 ARRANGEMENT  
 SHEET 2 OF 3

DRAWING NO: SZC-SZ0204-XX-000-DRW-10527 REVISION: 02

DATE: JAN 2021 DRAWN: DHP SCALE: 1:500 @ A1

SCALE BAR: 0 1:500 25 metres

See Drawing No: SZC-SZ0204-XX-000-DRW-100528

See Drawing No: SZC-SZ0204-XX-000-DRW-100526



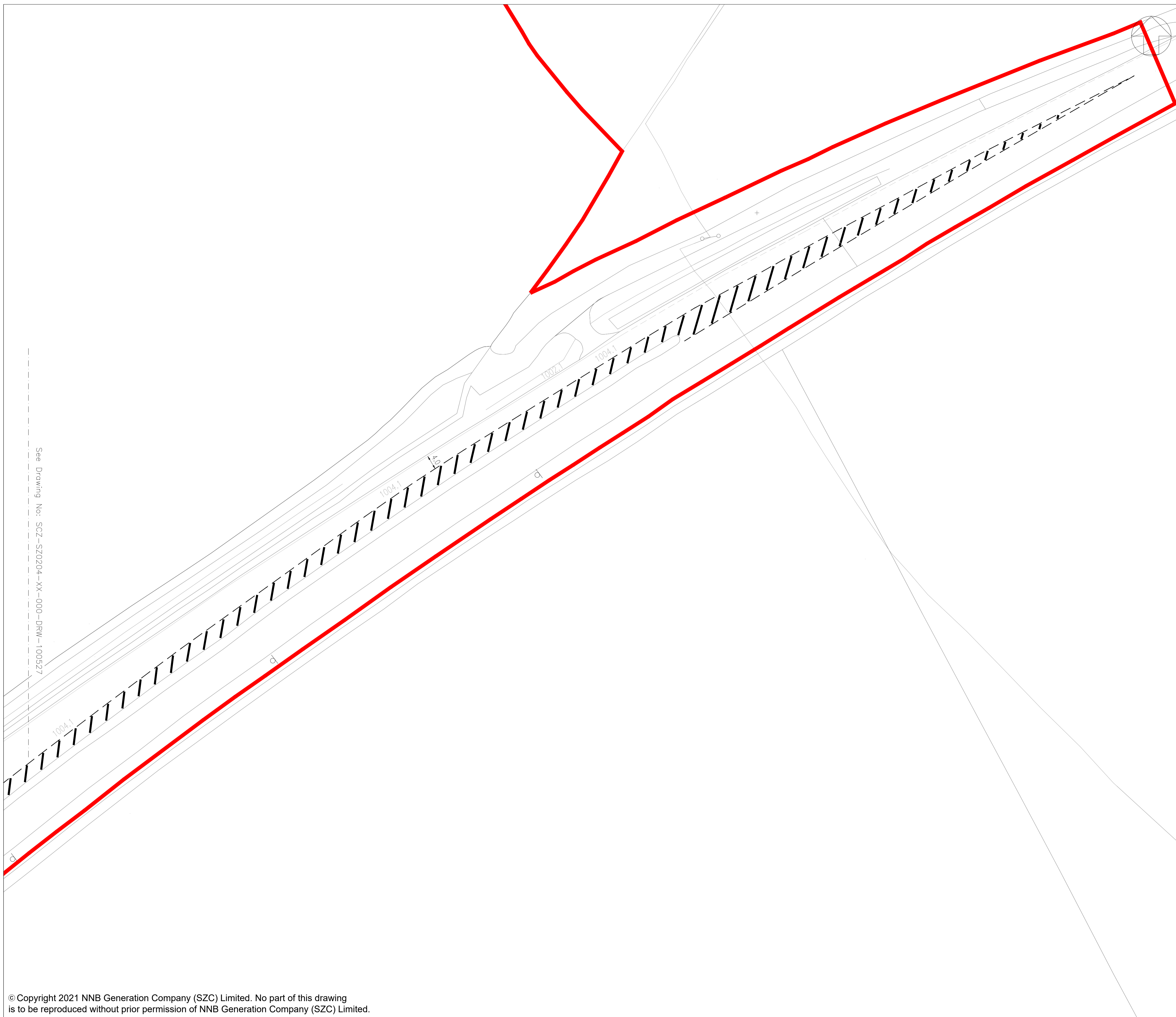

See Drawing No: SZC-SZ0204-XX-000-DRW-100527

- NOTES
1. THIS DRAWING IS FOR PLANNING PURPOSES ONLY AND SHALL NOT BE USED FOR CONSTRUCTION OR ANY OTHER PURPOSE.
  2. THE SCHEME DESIGN IS BASED ON ORDNANCE SURVEY MAPPING DATA. THE EXISTING GROUND TERRAIN AND PROPOSED SURFACES ARE BASED ON THE UK GOVERNMENT'S OPEN SOURCE LIDAR DIGITAL TERRAIN MAPPING DATA. ALL POSITIONS AND LEVELS ARE TO BE REVIEWED FOLLOWING COMPLETION OF A DETAILED SITE TOPOGRAPHICAL SURVEY.
  3. NEW SIGNS AND ROAD MARKINGS WILL BE BASED ON TSRGD 2016 OR AS AGREED WITH THE LOCAL HIGHWAY AUTHORITY.
  4. ALL DIMENSIONS IN METRES UNLESS STATED OTHERWISE.
  5. FOR DETAILS OF LANDSCAPING AND PLANTING REFER TO THE LANDSCAPE ARCHITECTS PLANS.
  6. ALL PROPOSED ROADWORKS ARE TO BE IN ACCORDANCE WITH THE DESIGN MANUAL FOR ROADS AND BRIDGES (DMRB) OR AS AGREED WITH LOCAL AUTHORITY.
  7. WHERE PROPOSED ROAD MARKINGS ARE SHOWN THE EXISTING ROAD MARKINGS ARE TO BE REMOVED AS APPROPRIATE.

- KEY:
- DEVELOPMENT SITE BOUNDARY
  - EXISTING LAY BY
  - PROPOSED ROAD MARKING

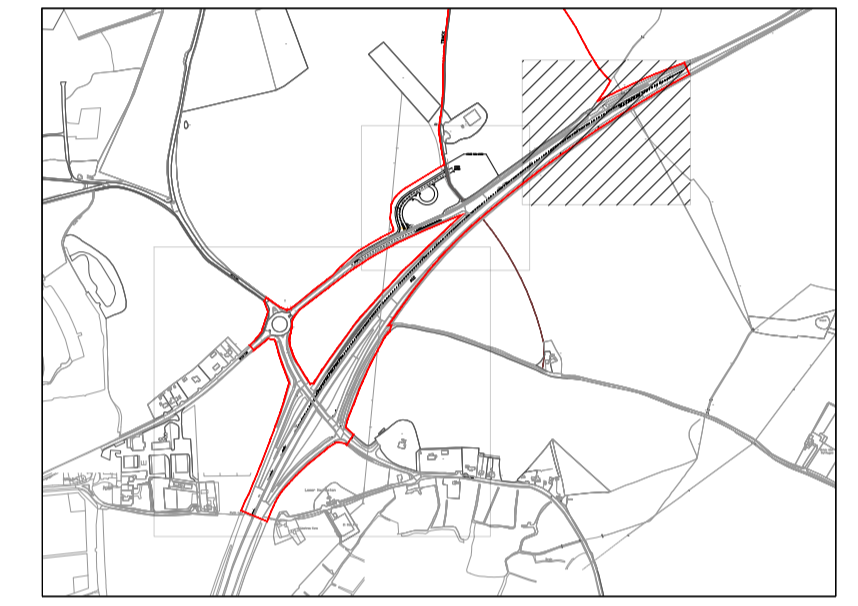

02	JAN 2021	DHP	HWP	PROPOSED CHANGES TO THE DCO APPLICATION - JANUARY	SZC Co
01	FEB 2020	DHP	HWP	DCO SUBMISSION	SZC Co
REVISION	DATE	DRAWN/CHECKED		REASONS FOR REVISION / COMMENTS	APPROVED

NOT PROTECTIVELY MARKED

**COPYRIGHT:**  
 Reproduced from Ordnance Survey map with the permission of Ordnance Survey on behalf of the controller of Her Majesty's Stationery Office © Crown copyright (2021). All Rights reserved. NNB GenCo Licence: 0100060408



PROJECT:  
 SIZEWELL C

DOCUMENT:  
 APPLICATION DRAWING -  
 FOR APPROVAL  
 REGULATION 5(2)(o)

DRAWING TITLE:  
 SOUTHERN PARK AND RIDE  
 HIGHWAY PROPOSED GENERAL  
 ARRANGEMENT  
 SHEET 3 OF 3

DRAWING NO: SZC-SZ0204-XX-000-DRW-100528      REVISION: 02

DATE: JAN 2021      DRAWN: DHP      SCALE: 1:500 @ A1

